

California Native Plants For the Lazy Gardener



Barbara Eisenstein, Lazy Gardener Wanna-Be

Consultant, writer, photographer, and
enthusiast of sustainable gardening with
California native plants

Website: www.weedingwildsuburbia.com

Email: barbara.eisenstein@gmail.com



Overview

- **Definitions**
- **Tips for Doing Less More Successfully**
- **The Plants**
- **References**





By definition a garden requires care.

Land that gets no care is a vacant lot, not a garden.

Photo credit: <http://uglyhousephotos.com/wordpress/?cat=8>



Before in Phoenix...



...and after.

<http://uglyhousephotos.com/wordpress/?p=15858#more-15858>



Low-maintenance

Garden looks the way you want it to...
with the amount of work you want to do...
without being wasteful.



Traditional Turf-dominated Landscapes

Are not low-maintenance.

- Just because someone else is doing the work doesn't make it easy or low-maintenance.
- High resource input: water, fuel, noise, labor, money, pesticides, etc.
- Maintenance is same all year around. Complete dominance over nature.



Care not Maintenance

- **Maintenance** implies domination over nature.
- **Caring** for your garden means working with nature:
 - Understand your yard and the plants in it.
 - Do different things at different times of the year.



11 Tips for Success

1. Take your gardening hints from nature.
2. Select plants that are compatible with your garden conditions and practices.
3. Group plants with similar requirements.
4. Don't crowd your plants. Choose plants that will fit their space when they are mature.
5. Select low-maintenance plants that don't accumulate dead stuff, don't need to be removed (annuals), don't need to be watered all of the time (containers).



11 Tips for Success

6. Time your maintenance well.
7. Less water and fertilizer mean less weeds.
8. Try to disturb the soil as little as possible.
9. Mulch is your friend.
10. Remove the plant if it takes too much work.
11. RELAX AND ENJOY YOUR GARDEN!



California Native Plants



Garden Themes from Nature

Oak Woodland

Riparian Woodland

Chaparral/Scrub/Grassland

Desert (high and low)



Oak Woodland

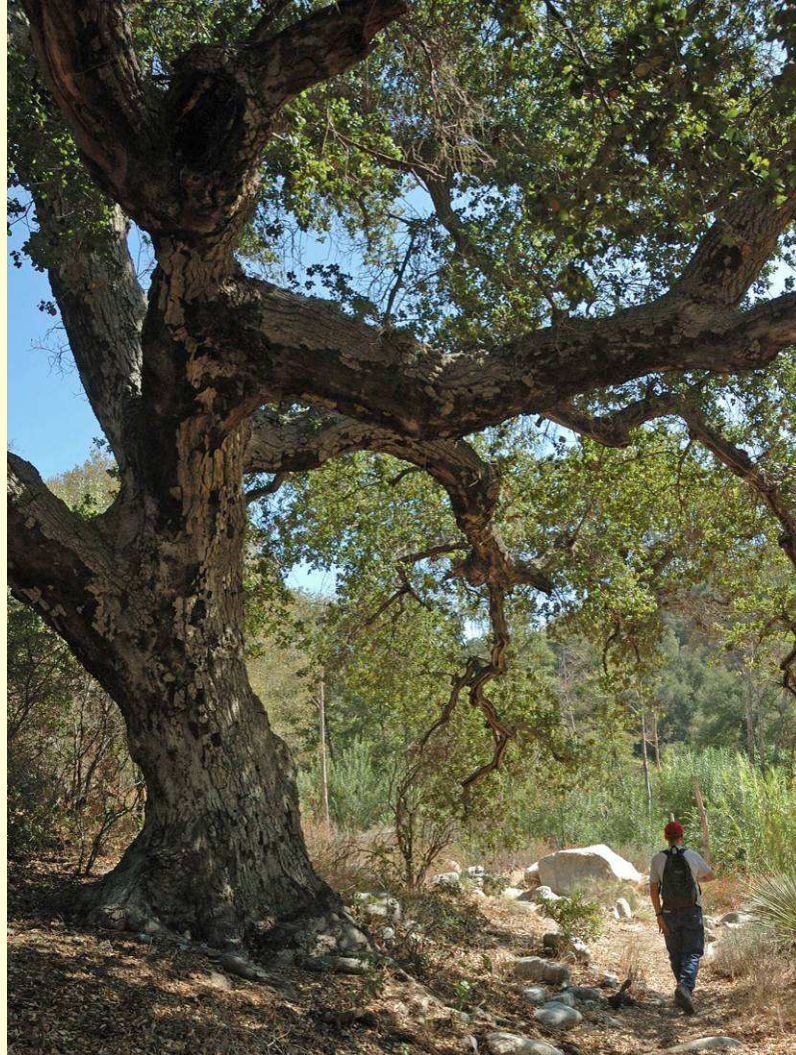

Oak Woodland Garden

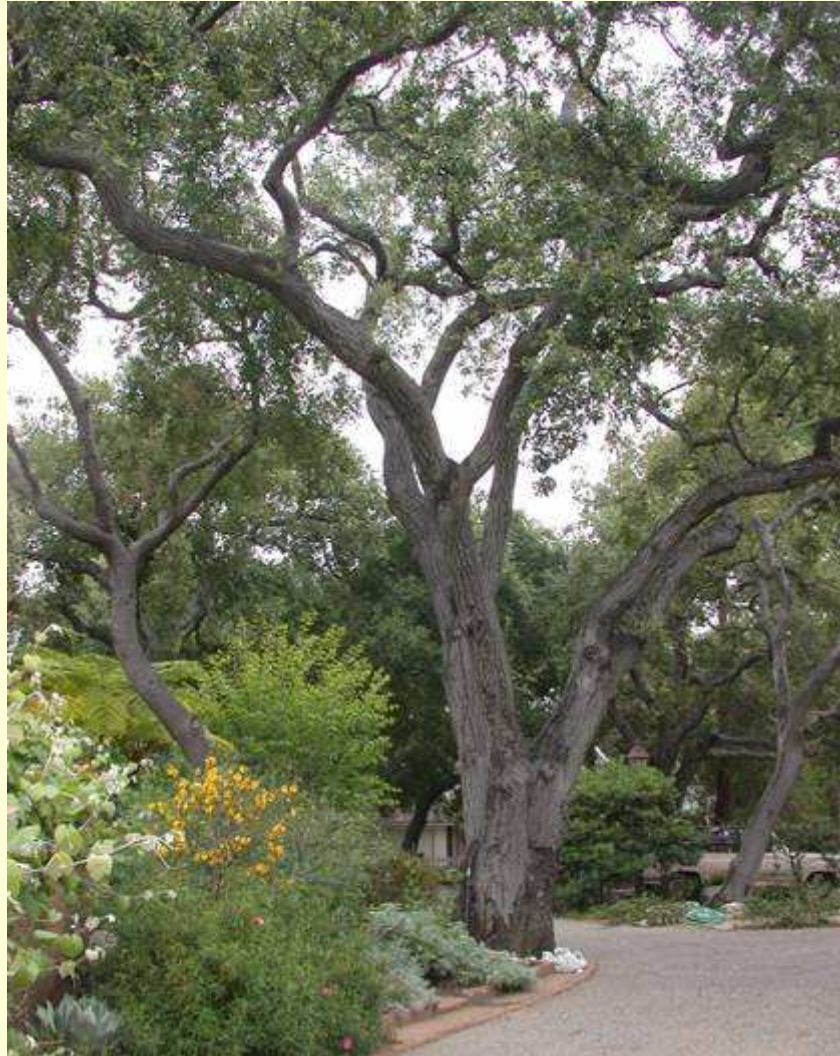

Coast Live Oak

Quercus agrifolia



Coast Live Oak

Quercus agrifolia



Howard McMinn Manzanita

Arctostaphylos 'Howard McMinn'



Howard McMinn Manzanita

Arctostaphylos 'Howard McMinn'



Ray Hartman Ceanothus

Ceanothus 'Ray Hartman'



Ray Hartman Ceanothus

Ceanothus 'Ray Hartman'



Toyon

Heteromeles arbutifolia



Golden Abundance Barberry

Mahonia 'Golden Abundance'



Golden Abundance Barberry

Mahonia 'Golden Abundance'



Coffeeberry

Rhamnus californica



Eve Case Coffeeberry

Rhamnus californica 'Eve Case'



California Fescue

Festuca californica



California Fescue

Festuca californica

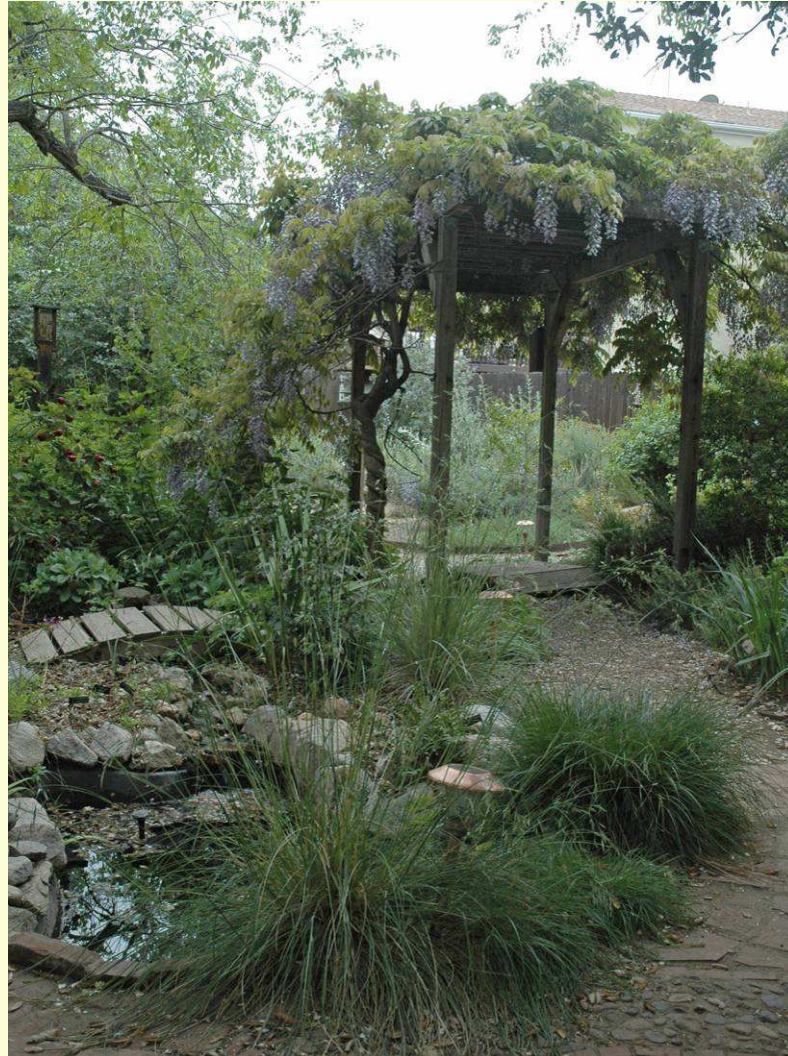

Riparian Woodland



Riparian Woodland Garden



Riparian Woodland Garden

July 2005



Riparian Woodland Garden

August 2002



Riparian Woodland Garden

March 2004



July 2005



Riparian Woodland Garden

May 2009

March 2010

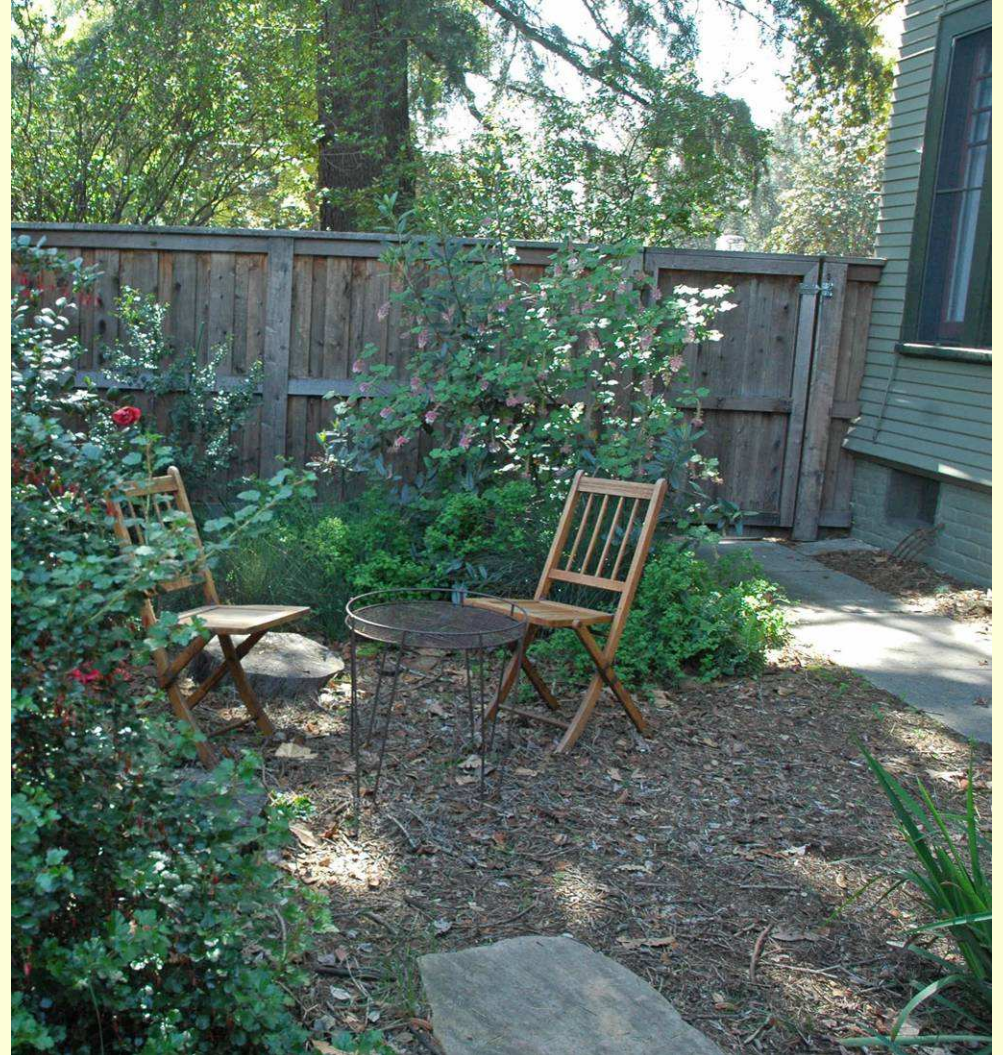

Riparian Woodland Garden

October 2009



Fuchsia-flowered Gooseberry

Ribes speciosum



Fuchsia-flowered Gooseberry

Ribes speciosum



Fuchsia-flowered Gooseberry

Ribes speciosum



Claremont Currant

Ribes sanguineum var. *glutinosum* 'Claremont'



Douglas Iris/ Pacific Coast Hybrid

Iris douglasiana; I. (PCH)



Douglas Iris/ Pacific Coast Hybrid

Iris douglasiana; I. (PCH)

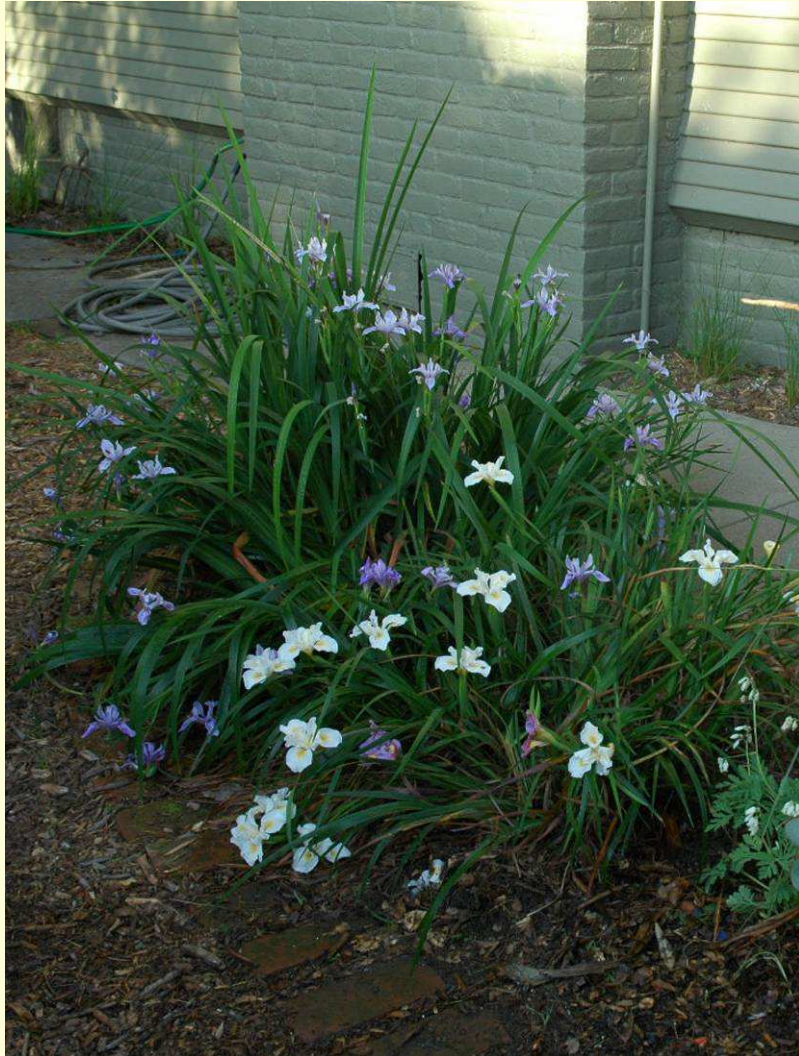

Wire Grass

Juncus species



Elk Blue Wire Grass

Juncus patens 'Elk Blue'



Coral Bells

Heuchera species and cultivars



Wendy Coral Bells

Heuchera 'Wendy'



Susanna Coral Bells

Heuchera 'Susanna'



Coral Bells

Heuchera maxima



Giant Chain Fern

Woodwardia fimbriata



Coastal Sage Scrub



Chaparral



Grassland



Scrub/Chaparral Garden



Scrubland Garden



Chaparral/Scrubland Garden



Scrub/Grassland Garden



Bigberry Manzanita

Arctostaphylos glauca



Bigberry Manzanita

Arctostaphylos glauca



Lester Rowntree Manzanita

Arctostaphylos 'Lester Rowntree'



Toyon

Heteromeles arbutifolia



Nevin's Barberry

Berberis nevinii [Mahonia]



Laurel Sumac

Malosma laurina



Laurel Sumac

Malosma laurina



Deer Grass

Muhlenbergia rigens



Deer Grass

Muhlenbergia rigens



Deer Grass

Muhlenbergia rigens



Deer Grass

Muhlenbergia rigens



Deer Grass

Muhlenbergia rigens



Deer Grass

Muhlenbergia rigens



<http://deborahsmall.wordpress.com/2010/01/16/basket-sumac-rhus-trilobata/>

Canyon Prince Giant Rye

Leymus condensatus 'Canyon Prince'



Canyon Prince Giant Rye

Leymus condensatus 'Canyon Prince'



Canyon Prince Giant Rye

Leymus condensatus 'Canyon Prince'



Canyon Prince Giant Rye

Leymus condensatus 'Canyon Prince'



Canyon Prince Giant Rye

Leymus condensatus 'Canyon Prince'

April 2007



Canyon Prince Giant Rye

Leymus condensatus 'Canyon Prince'



De La Mina Verbena

Verbena lilacina 'De La Mina'



De La Mina Verbena

Verbena lilacina 'De La Mina'



Chaparral Yucca

Yucca whipplei



White Sage

Salvia apiana



Bee's Bliss Sage

Salvia 'Bee's Bliss'



Bee's Bliss Sage

Salvia 'Bee's Bliss'

Dec. 2005



Dec. 2004



W.R. Seaside Daisy

Erigeron 'W. R.'



Purple Needlegrass

Nassella pulchra



Purple Needlegrass

Nassella pulchra



Desert



Desert



Desert



Desert Gardens



Mojave or High – more frost



Colorado or Low - less frost

Joshua Tree

Yucca brevifolia



Desert Willow

Chilopsis linearis



Mojave Yucca

Yucca schidigera



Desert Mallow

Abutilon palmeri



Fairy Duster

Calliandra eriophylla



Beavertail Cactus

Opuntia basilaris var. *basilaris*



Four O'clock

Mirabilis multiflora var. *pubescens*



June

Four O'clock

Mirabilis multiflora var. *pubescens*



October

Evening Primrose

Oenothera caespitosa



WRITTEN REFERENCES ON GARDENING WITH CA NATIVE PLANTS

- Bornstein, Carol; David Fross and Bart O'Brien. 2005. California Native Plants for the Garden. Los Olivos, CA: Cachuma Press.
- Brenzel, Kathleen Norris, Ed. 2001. Sunset Western Garden Book. Menlo Park, CA: Sunset Publishing.
- Lenz Lee W.; John Dourley. 1981. California Native Trees & Shrubs. Claremont, CA: RSABG.
- Lowry, Judith Larner. 1999. Gardening with a Wild Heart. Berkeley, CA: UC Press.
- O'Brien, Bart C. 2002. "California Native Plant Gardens – Care and Maintenance." Claremont, CA: Rancho Santa Ana Botanic Garden.
- O'Brien, Bart; Betsey Landis and Ellen Mackey. 2006. Care & Maintenance of Southern California Native Plant Gardens. Los Angeles, CA: Metropolitan Water District of Southern California.
- Perry, Bob. 2010. Landscape Plants for California Gardens. Claremont, CA: Land Design Publishing.
- Perry, Bob. 1992. Landscape Plants for Western Regions: An Illustrated Guide to Plants for Water Conservation. San Dimas, CA: Land Design Publishing.
- Pittenger, Dennis R., editor. California Master Gardener Handbook. Oakland, CA: UC ANR Publication 3382.
- Sawyer, John and Todd Keeler-Wolf. 1995. A Manual of California Vegetation. Sacramento, CA: CNPS.
- Schmidt, Marjorie G. 1980. Growing California Native Plants. Berkeley, CA: UC Press.
- Tallamy, Douglas. 2009. Bringing Nature Home. Portland, OR: Timber Press.
- **Tree of Life. "Plants of the El Camino Real."**



WEB REFERENCES ON GARDENING WITH CA NATIVE PLANTS

Nurseries and Gardens with plant databases, lists of plants for native gardens, most with photos (some are not exclusively devoted to CA native plants)

- El Nativo, <http://www.elnativogrowers.com/Natives.htm>
- Las Pilitas Nursery, <http://www.mynativeplants.com/>
- Mountain States Wholesale Nursery, <http://www.mswm.com/>
- Native Sons, <http://www.nativeson.com/home2.html>
- Rancho Santa Ana Botanic Garden, <http://www.rsabg.org/>
- San Marcos Growers, <http://www.smgrowers.com/>
- Suncrest Nurseries, <http://www.suncrestnurseries.com/> (no photos)
- Theodore Payne Foundation, <http://www.theodorepayne.org/>
- **Tree of Life Nursery, <http://www.californianativeplants.com/>**

Photo collections/databases

- CalFlora, database of native plant photos, <http://www.calflora.org>
- California Native Plant Link Exchange, database with links to photos, info, <http://www.cnplx.info/index.html>
- California Native Plant Society, <http://www.cnps.org/gallery/index.htm>
- Cal Photos, database of native plant photos, <http://calphotos.berkeley.edu/flora/>
- Jepson Floral Project, Jepson Online Interchange, <http://ucjeps.berkeley.edu/interchange.html>
- LA Dept. of Public Works, Los Angeles River Master Plan Landscaping Guidelines and Plant Palettes, (plant lists start on pg. 124) http://ladpw.org/wmd/watershed/LA/LAR_planting_guidelines_webversion.pdf
- Los Angeles/San Gabriel Rivers Watershed Council, The Plant Profiler, <http://theplantprofiler.com/>
- Southern California Wildflowers and Other Plants, <http://www.calflora.net/bloomingplants/index.html>

Google image search of plant



BLOGS ON GARDENING WITH CA NATIVE PLANTS

begarden - <http://begarden.blogspot.com/>

Breathing Treatment - <http://bammorgan.blogspot.com/>

GardenNatives.com - <http://gardennatives.blogspot.com/>

deborah small's ethnobotany blog - <http://deborahsmall.wordpress.com/>

Garden of Native Plants - <http://www.gardenofnativeplants.com/>

Hey Natives - <http://heynatives.blogspot.com/>

[Lost in the Landscape] - <http://www.soenyun.com/Blog/>

Native by Design - <http://nativebydesign.blogspot.com/>

Native Sanctuary - <http://nativesanctuary.wordpress.com/>

Poppy and Sage - <http://poppyandsage.blogspot.com/>

Rooted in California - <http://rootedincalifornia.blogspot.com/>

Town Mouse and Country Mouse - <http://tmousecmouse.blogspot.com/>





HOME PHOTOS LINKS ARTICLES PRESENTATIONS BLOG PLANT LISTS

WEDNESDAY, OCTOBER 28, 2009

What do you mean, you didn't mean that deck?



And the work goes on.

About Me



Barbara is an avid native plant gardener who loves to play in the garden. Until recently she staffed the Garden Hotline at Rancho Santa Ana Botanic Garden and is now an RSABG Research Associate.

[View my complete profile](#)

What I'm Doing In My Garden

- ◆ October 22: remove spurge, cut back sage, cut dry grass flowers
- ◆ September 22: sow snap, sugar and ornamental peas next to new trellis
- ◆ September 16: prepare



Weeding Wild Suburbia

Adventures with Native Plants

- HOME
- PHOTOS
- LINKS
- ARTICLES
- PRESENTATIONS
- BLOG
- PLANT LISTS

PRESENTATIONS

All links open as PDFs in a new window

- ◆ California Native Plants Belong in Your Garden (12 MB)
- ◆ California Native Plants Belong in Your Garden, Plant List (197 KB)
- ◆ Easy Care for a California Native Plant Garden (11.7 MB)
- ◆ Easy Care for a California Native Plant Garden, Plant List (197 KB)
- ◆ Easy Gardening with California Native Plants (9.5 MB)
- ◆ Easy Gardening with California Native Plants, Plant List (182 KB)
- ◆ Plant Care (6 MB)
- ◆ Plant Selection (18 MB)
- ◆ Native Grasses, Sedges and Rushes(10 MB)
- ◆ Garden Care Schedule (16 KB)